

**ADDENDUM #1 - ASBESTOS INSPECTION
2223-10 HVAC IMPROVEMENTS AT CHS**

ChemScope *INDUSTRIAL HYGIENE • ENVIRONMENTAL CHEMISTRY*

15 Moulthrop Street, North Haven CT 06473-3686 • Phone (203) 865-5605 • www.chem-scope.com

Richard Clavet
Cheshire Public Schools
29 Main Street
Cheshire CT 06410

11/9/2022

**ASBESTOS PRE-RENOVATION INSPECTION
CHESHIRE HIGH SCHOOL – 525 SOUTH MAIN STREET, CHESHIRE CT
HVAC IMPROVEMENT PROJECT
CS# 206-595, 11/8/2022, PAGE 1 OF 5**

TABLE OF CONTENTS

Contents	Page(s)
Table of Contents	1
Introduction	2
Inspection Report Synopsis	3-4
Limitations of the Inspection	4
Recommendations	5

Attachments:

- Scope of Inspection Drawing (1 page)
- ACM Location Drawing (1 page)
- 11/9/2022 Certificate of Analysis Report (3 pages)
- Chain of Custody Document (2 pages)
- Sample Location Drawing (1 page)
- Inspector Qualifications and Laboratory Certifications (5 pages)

Report Distribution:

Richard Clavet rclavet@cheshire.k12.ct.us

Cc: Victor Sandoval – Cheshire Public Schools (via email vsandoval@cheshire.k12.ct.us)
Daniel J. Bombero, Jr dbombero@cheshirect.org

File Location:

NAS AAUM-Reports\Asblnsp\ZW\ZW-PRERENO_2022.doc

**ASBESTOS PRE-RENOVATION INSPECTION
CHESHIRE HIGH SCHOOL – 525 SOUTH MAIN STREET, CHESHIRE CT
HVAC IMPROVEMENT PROJECT
CS# 206-595, 11/8/2022, PAGE 2 OF 5**

INTRODUCTION

EXECUTIVE SUMMARY: Asbestos containing materials (ACM) were detected within the scope of this inspection and will need to be properly removed (abated) and disposed of prior to any renovation that would disturb these materials. Abatement work must be done by a licensed asbestos abatement contractor using proper procedures and practices with licensed and certified individuals. Please see the Recommendations Section for details. At a minimum for abatement while school is not in session or when children are not in the school, the school system must send a letter to the CT-DPH to inform them of the abatement and that no children/students will be in the school building at the time of the abatement.

SITE DESCRIPTION: The Cheshire High School is a two-story building with a total area of about 229,061 sq ft constructed of steel and masonry. There are two stories of classrooms and offices, the lower level of which includes custodial work areas, recreational areas, the boiler room, shop areas, gymnasium, and the auditorium. The original building was constructed in 1951-1955 totaling about 59,516 sq ft. In 1956, 1961, 1971 their additions put on totaling about 170,000 sq ft. In 1975 a portable building totaling 800 sq ft was added.

PURPOSE AND SCOPE OF INSPECTION: Asbestos Pre-Renovation Inspection as directed by Rich Clavet. We understand that there are plans to remove existing heating ventilators at the subject school. It is our understanding that the renovation plans include the removal of the existing ventilator units, existing metal louvers, associated piping, portion of existing ceilings and flooring. We understand that this work is to take place in the follow classrooms, 43, 45, 47, 49, 51, 53, 55, 88, 90, 92 and 93. We understand that you would like ChemScope to conduct the required asbestos pre-renovation inspection prior to the start of any work.

No other materials or areas were in the scope of the inspection.

TEST PARAMETERS: This is an Asbestos Pre-Renovation Inspection which is required by the EPA NESHAP Regulations for Building Renovations and Demolition, 40 CFR PART 61 intended to thoroughly inspect the affected part of the facility for asbestos prior to the renovation. The inspection is also needed for compliance with OSHA 1926.1101 and CT DPH 19a-332a-1 through 16.

Sampling completed following the Methods outlined in ChemScope QA Plan, which is based on AHERA 40 CFR Part 763. EPA Wet Methods are used to prevent fiber release. The building materials sampled are analyzed at our laboratory by EPA method 600/R-93/116. This is currently the approved EPA Test method, which uses Polarized Light Microscopy with Dispersion Staining. The laboratory is accredited by NIST/NVLAP and AIHA Lab Accreditation Program, LLC, and is a Connecticut Approved Environmental Laboratory for Asbestos Analysis.

This investigation and the information provided in this report depend partly on background information provided by the client. This report is intended for the use of the client. The scope of services performed may not be appropriate for other users and any use of this report by third parties is at their sole risk. This report is intended to be used in its entirety. No excerpts may be taken to be representative of this report.

**ASBESTOS PRE-RENOVATION INSPECTION
 CHESHIRE HIGH SCHOOL – 525 SOUTH MAIN STREET, CHESHIRE CT
 HVAC IMPROVEMENT PROJECT
 CS# 206-595, 11/8/2022, PAGE 3 OF 5**

INSPECTION REPORT SYNOPSIS

LOCATION NAME AND ADDRESS: Cheshire High School
 525 South Main Street, Cheshire CT

INSPECTION DATE(S): 11/8/2022

QUALIFICATIONS: The Inspection was conducted by Ziyang Wang:

Mr. Wang is certified as follows:

- EPA and State of Connecticut Accredited Asbestos Inspector.
- State of Connecticut Licensed Asbestos Inspector (#000876)
- State of Connecticut Licensed Asbestos Project Monitor (#000755)

SITE OBSERVATIONS: On site, we met with custodian Eric who showed us the scope, we made the following observations:

- The subject building was unoccupied during the inspection.
- The floor, wall, and ceilings within the scope were intact.
- The Asbestos Management Plan showed that the flooring in the classrooms 43, 49, 51, 53, 55, 88, 90 and 92 are ACM, based on post sample results.

FINDINGS: The following asbestos containing materials (ACM) were detected within the Scope of the Inspection:

<u>MATERIAL</u>	<u>LOCATION</u>	<u>~FOOTAGE</u>	
*Beige hard 9x9 floor tile with black, white, and orange streaks on black sticky ACM mastic (on concrete)	Room 43	30 SF**	575 SF
	Room 49	30 SF**	645 SF
	Room 51	30 SF**	645 SF
	Room 53	30 SF**	645 SF
	Room 55	30 SF**	645 SF
*Light tan hard 12x12 floor tile with blue/orange streaks on black sticky ACM mastic (on concrete)	Room 45	15 SF**	700 SF
*Off-white hard 12x12 floor tile with orange streaks on *tan sticky mastic on *gray hard leveler on black sticky AC mastic (on concrete)	Room 47	15 SF**	310 SF
Beige hard 9x9 floor tile with white and brown streaks on black sticky ACM mastic (on concrete)	Room 88	30 SF**	675 SF
	Room 90	30 SF**	675 SF
	Room 92	30 SF**	675 SF
	TOTAL	270 SF	

*The material attached to this material contains asbestos, therefore will need to be treated as ACM.

**Quantity represents amount of the flooring within the scope of inspection only.

**ASBESTOS PRE-RENOVATION INSPECTION
CHESHIRE HIGH SCHOOL – 525 SOUTH MAIN STREET, CHESHIRE CT
HVAC IMPROVEMENT PROJECT
CS# 206-595, 11/8/2022, PAGE 4 OF 5**

INSPECTION REPORT SYNOPSIS (cont.)

The following is a summary table of the materials that tested as non-Asbestos Containing Material (ACM) (<1%) within the Scope of Work (not already summarized above):

Location	Material	Sample #'s	Findings
Throughout the scope	Light gray crumbly 2x2 suspended ceiling tile with white face (from ceiling)	206-595-7***	No Asbestos Detected
Room 93	Beige hard 12x12 floor tile with brown, green, white, and gray streaks on black mastic (on concrete)	N/A****	No Asbestos Detected

*** Confirmatory sample only.

****Based on the Asbestos Management Plan.

LIMITATIONS OF INSPECTION

The heating ventilators and above the metal ceilings were inaccessible during the inspection.

The roof is said to be an EPM rubber membrane roof, and is not in the scope of our inspection, as directed by our client.

It is important to note that every effort is made to detect asbestos (ACM) in the path of the renovation by our inspectors. It is not practical or prudent to demolish the work area during an inspection. The owner should be aware of this in case suspect materials or concealed suspect materials are uncovered during the actual renovation.

If suspect materials that were previously not accessible or not sampled during this inspection are discovered during the renovation, or if the scope of the renovation changes to include disturbance of new materials not inspected, then renovation must stop, and the materials must be sampled by a CT DPH licensed asbestos inspector prior to disturbance of these materials.

**ASBESTOS PRE-RENOVATION INSPECTION
CHESHIRE HIGH SCHOOL – 525 SOUTH MAIN STREET, CHESHIRE CT
HVAC IMPROVEMENT PROJECT
CS# 206-595, 11/8/2022, PAGE 5 OF 5**

RECOMMENDATIONS

All Asbestos Containing Materials (ACM) detected in the path of the renovation must be removed prior to further disturbance of these materials.

Please also keep in mind that notification to the DPH is required for asbestos abatement involving greater than 10 linear feet or 25 square feet of or for any demolition. Disposal of all ACM is regulated by EPA and the Connecticut DEEP; an EPA approved landfill must be used.

OSHA regulations 1926.1101 requires that before asbestos removal or repair work (class I, II or III work) is initiated, building owners/facility owners must notify their own employees and employers who are bidding on such work, of the quantity and location of ACM or PACM (presumed asbestos containing material) present in such areas. Also, for inadvertently discovered ACM or PACM there is a 24-hour notification requirement to the owner and all employers at the site.

Notification to the EPA is also required for projects involving any demolition regardless of regulated asbestos containing material (RACM) amount or renovation which may disturb more than 260 linear feet or 160 square feet of RACM.

Section 19a-333-7 of the Regulations of Connecticut State Agencies prohibits the performance of asbestos abatement in a school building while school is in session (or at any time while children are in the school) without the prior written approval of the DPH. This includes interior asbestos abatement, and it is the interpretation of the DPH Asbestos Program that the removal of exterior friable asbestos-containing material constitutes asbestos abatement, as defined by Connecticut General Statute Section 19a-332. Therefore, a local education agency is required to obtain the prior written approval of the DPH to remove the interior and exterior friable materials at this site while school is in session.

At a minimum for abatement while school is not in session or when children are not in the school, the school system must send a letter to the CT-DPH to inform them of the abatement and that no children/students will be in the school building at the time of the abatement.

Sincerely,

Ziyang Wang



Asbestos Inspector

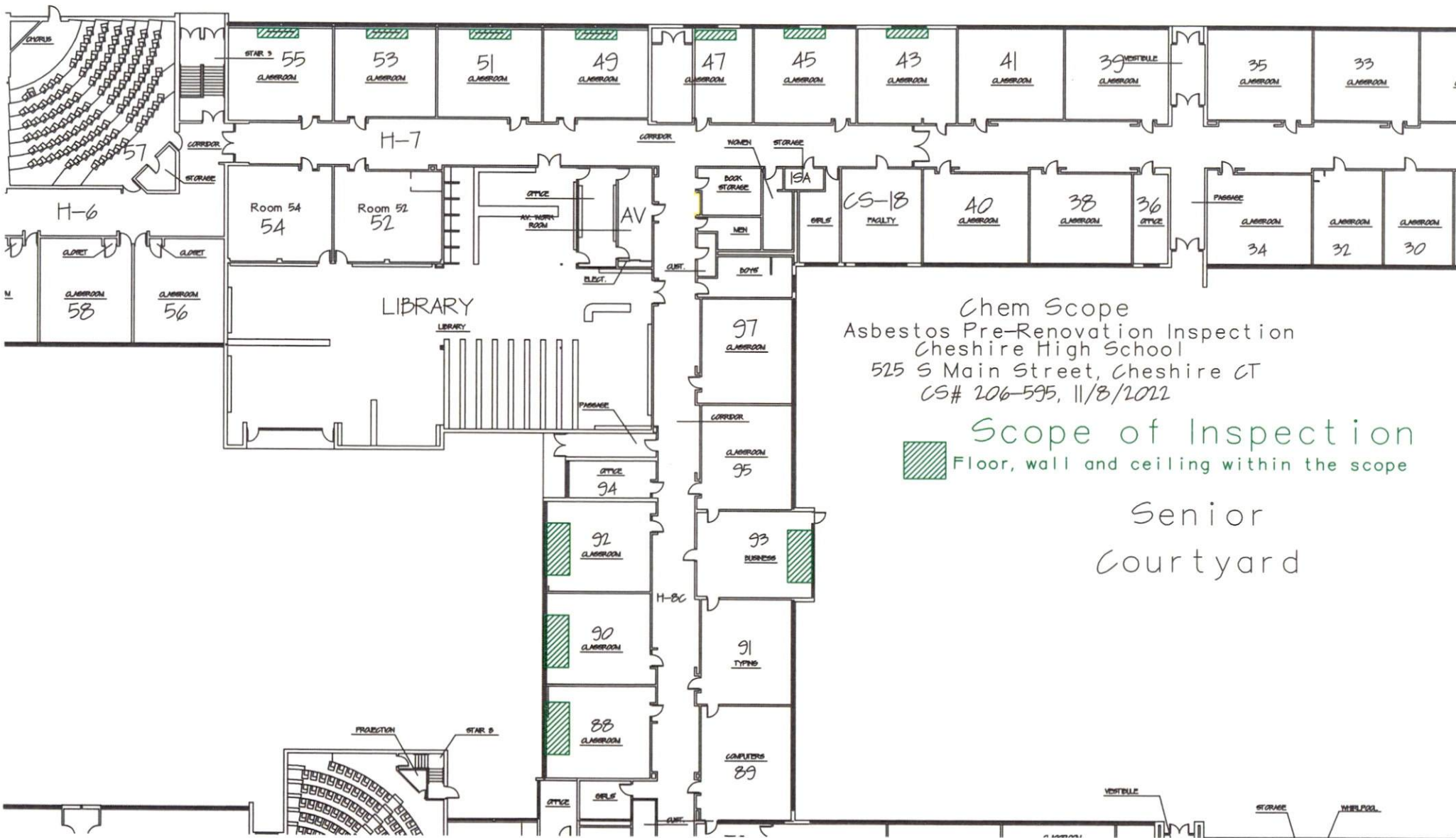

Chem Scope
 Asbestos Pre-Renovation Inspection
 Cheshire High School
 525 S Main Street, Cheshire CT
 CS# 206-595, 11/8/2012

Scope of Inspection
 Floor, wall and ceiling within the scope

Senior
 Courtyard



Chem Scope
 Asbestos Pre-Renovation Inspection
 Cheshire High School
 525 S Main Street, Cheshire CT
 CS# 206-595, 11/8/2012

ACM Location Drawing
 ACM flooring location

Senior
 Courtyard

Certificate Of Analysis

Cheshire Public Schools
29 Main Street
Cheshire CT 06410

11/09/2022
CS#: 206-595
Page 1 of 3

Bulk sample(s) from Cheshire High School, 525 South Main Street, Cheshire, CT collected by Ziyang Wang on 11/08/2022

Examination made by Polarized Light Microscopy (PLM) per EPA Appendix E to Subpart E of 40 CFR Part 763 and EPA Test Method 600/R-93/116

Sample Identification

206-595-1 Light tan hard 12x12 floor tile with blue/orange streaks (on black sticky mastic on concrete)/Room 45

Findings (Analyzed 11/09/2022)

Not Analyzed

206-595-2 Black sticky mastic (from # 1)/Room 45

5% Chrysotile Asbestos
(*Confidence Interval = 3.8% - 6.6%)
21% Non Fibrous Particles
74% Volatile on Ignition
*Estimate of the Error @ 95% Confidence Level

206-595-3 Off-white hard 12x12 floor tile with orange streaks (on tan sticky mastic on gray hard leveler on black sticky mastic on concrete)/Room 47

Not Analyzed

206-595-4 Tan sticky mastic (from # 3)/Room 47

Not Analyzed

206-595-5 Gray hard leveler (from # 3)/Room 47

Not Analyzed

Bulk sample(s) from Cheshire High School, 525 South Main Street, Cheshire, CT collected by Ziyang Wang on 11/08/2022

Examination made by Polarized Light Microscopy (PLM) per EPA Appendix E to Subpart E of 40 CFR Part 763 and EPA Test Method 600/R-93/116

Sample Identification

206-595-6 Black sticky mastic (from # 3)/Room 47

206-595-7 Light gray crumbly 2x2 ceiling tile (from ceiling)/Room 49

Findings (Analyzed 11/09/2022)

17% Chrysotile Asbestos
(*Confidence Interval = 12.8% - 21.8%)
52% Non Fibrous Particles
31% Volatile on Ignition
*Estimate of the Error @ 95% Confidence Level

No Asbestos Detected
34% Non Fibrous Particles
50% Mineral Wool
16% Volatile on Ignition

**PARAMETERS
ASBESTOS PLM ANALYSIS
(Revised 12/9/19)**

1. *Materials which contain >1% asbestos (greater than 1%) by PLM (polarizing light microscopy) analysis are considered to be asbestos containing materials under EPA and the State of Connecticut Regulations. OSHA still regulates material with <1%. (Contact laboratory for information.) {Note: A more sensitive method is available called TEM (transmission electron microscopy). TEM may detect asbestos fibers that PLM cannot see, but the above agencies' enforcement is based on PLM analysis. Rules may differ for states other than Connecticut. It is best to check with the individual state. For example, New York State requires TEM confirmation of negative PLM results on floor tile}.*
2. *If no asbestos is detected in a sample, or if the asbestos content is less than 1 % by PLM, additional samples of the same material should be submitted for confirmation. Please check with the laboratory for guidance on the number of samples needed. Sample collection in Connecticut must be by a DPH Licensed Asbestos Inspector. Many other states also require licensing.*
3. *Floor Tile Mastic: Mastic under floor tile should be separately sampled by scraping some of the mastic from the floor to avoid contamination from the floor tile.*
4. *Although ChemScope, Inc. takes great effort to insure accuracy in the estimation of asbestos in the materials analyzed, no quantitation method is without some uncertainty. Based on independent calibration studies and comparison of ChemScope's quantitative results with NVLAP and AIHA, LAP programs we estimate our relative error (@ 95% Confidence Level) to be 0.26%. This means an estimated 10% asbestos has a Confidence Interval of 7.4-12.6% Asbestos. Likewise, a sample with an estimated 1% asbestos has a Confidence Interval of 0.74-1.26% Asbestos.*
5. *The presence of non-asbestos components, which are recognized by the PLM analyst, are reported with the estimated amounts. This is not an exhaustive analysis for the non-asbestos materials since the primary purpose is to determine if asbestos is present and, if so, how much is present of each type of asbestos.*
6. *Results reported apply only to the sample(s) analyzed.*
7. *Special treatment of samples: Chem Scope, Inc. routinely uses gravimetric sample reduction techniques such as low temperature ashing or acid dissolution on samples like floor tile, roofing materials, glue dots, or high cellulose content samples prior to PLM analysis. These methods are used to aid in the PLM analysis and to provide better quantitative data. Layered samples, if possible, are analyzed separately as individual layers. However, in accordance with the method, if any layer contains >1% asbestos (greater than 1%) it is to be considered an asbestos containing material. All results are reported to the original sample basis.*
8. *Sample results are not corrected for blanks. Analytical blanks are run daily and if contamination is suspected the samples are rerun.*
9. *Chem Scope, Inc. performs "400 point" point counting when the asbestos content is visually estimated to be less than 10%. There is no additional charge for this analysis.*

The Scope of Accreditation referenced in this report applies to bulk asbestos fiber analysis by PLM (Polarized Light Microscopy).

Accreditation does not imply endorsement by NVLAP, NIST or any Federal or State Agency.

This report pertains only to the samples tested and may not be reproduced in part.

Condition of the samples at the time of receipt was acceptable unless otherwise noted on the Certificate of Analysis.

See test parameters above and on attached chain of custody form.



We would love to hear from you. Comments? Questions? Please call or email us at chem.scope@snet.net

ChemScope, Inc. is accredited by AIHA LAP, LLC LAB #100134

NVLAP Lab Code 101061-0.

Connecticut Department of Public Health (DPH) Approved Environmental Lab PH 0581

Rhode Island Department of Health - Asbestos Program Certification #PLM00070

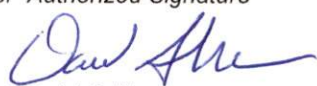
<i>Signature</i> 	<i>Signature</i> <i>(if applicable)</i> 	<i>Authorized Signature</i>	<i>Authorized Signature</i>	<i>or</i>	<i>Authorized Signature</i> 
Analyst	Inspector	Suzanne Cristante Laboratory Director	Izabela Kremens Quality Manager		Daniel Sullivan President

ChemScope

INDUSTRIAL HYGIENE • ENVIRONMENTAL CHEMISTRY

15 Moulthrop Street, North Haven, CT 06473-3686 • Phone (203) 865-5605 • Fax (203) 498-1610

Form FL-4 Rev 11/12/13
(Issued By SC)

Chain of Custody

Emailed _____
Faxed _____
Called _____
Logged _____

Sample Source: Cheshire High School
525 South Main Street, Cheshire, CT CS Job # 206-595

Sampled By: BW Date Sampled: 11/8/22 Customer Name: Cheshire Public Schools

CS Sample#	Client Sample#	Sample Description	Comments
<u>206-595-(4-7)</u>		<u>See attached</u>	

Sample Turnaround: 1 week 24 hr

Analysis Requested (if variable, use comment column): PLM

Check if you want sample returned _____ (sample will be disposed of after 30days).

Relinquished by BW Date 11/8/22 Time 11:40am Received By Lab [Signature]

Relinquished by _____ Date _____ Time _____ Received By _____

Other Special Instructions: _____

Result Transmittal Instructions (for Chem Scope to transmit): Tell BW.

FOR CHEM SCOPE, INC. TO FILL OUT IF SAMPLES ARE GOING TO OUTSIDE LABORATORY:

Name of Laboratory: _____

Method of Transportation to Laboratory: _____

Result Transmittal Instructions (for outside Laboratory to Chem Scope, Inc):

The person submitting samples is responsible for obtaining true and representative samples, for complying with applicable regulations and for the use of the data obtained from the analysis. For example, many states have licensing and laboratory approval requirements. Please contact the individual states if you have any questions regarding specific sampling or approval requirements. For Connecticut, sites we have licensed inspectors available to collect client samples and to perform building inspections.

Dear Laboratory Customer or Potential Customer,

New laboratory accreditation standards require us to provide our clients information about our services to make sure that your requirements for testing are adequately defined, documented and understood. The following is for your information. Please call us if you have any questions or comments.

Type of Samples

// PCM cassettes are routinely run by NIOSH Method 7400. (Issue #3, 14 June 2019)

// Bulk materials are run per EPA Appendix E to subpart of 40CFR part 763 and EPA Test method 600/R-93/116

Air Samples: NIOSH 7400 Method counts all fibers. This method may be used for personal air samples and for finals. Two field blanks must be submitted for each set of samples. In the unlikely event that there is to be any deviation from the standard test, you will be consulted by phone before the work begins. Those clients who have not had NIOSH 582 or AHERA asbestos training courses (either supervisor or project monitor) should consult with the lab director for more information. The test parameters are further explained in the analytical report.

Bulk materials: sampled are analyzed by the latest EPA Method: (#600/R-93/116) which uses polarized light microscopy (PLM). When asbestos is detected and the amount is estimated to be less than 10%, we automatically point count the samples. When there are interfering substances present, we may use ashing, acid washing or other procedures described in the method to handle the interference. Those clients who have not had AHERA asbestos training courses (either inspector, supervisor or project designer) should consult with the lab director for more information. The test parameters are further explained in the analytical report.

All Samples must be clearly labeled with source name and identification number or sufficient information from the client to make this sample uniquely identified. (We will then add our notebook #, page # (batch) and unique number within the batch.) Samples must be in a clean, air tight package such as a zip loc bag. Appropriate completed paperwork must accompany the sample. Bulk and air samples may not be submitted in the same package.

As soon as available bench top results will be faxed to you and reports will then be mailed. We will retain air samples for at least three months and bulk samples for 6 months unless you advise us otherwise.

You are welcome to visit the laboratory at any time to discuss the work, monitor the work or verify our testing services. We appreciate your business and encourage any feedback regarding improving our services or our quality system. Please take a minute to complete the following survey and mail/fax it to ChemScope, Inc.

Customer Service Survey

To help us improve our services give your opinions to the following:

1- The printed laboratory report was complete and easy to understand. YES__ NO__
If no, please explain _____.

2- The turn around time for results met your expectations/needs. YES__ NO__
If no, please explain _____.

3- How likely are you to recommend ChemScope Inc. to someone?
Excellent__ Very Good__ Good__ Fair__ Poor__

4- How likely are you to return to ChemScope in the future if the need arises?
Excellent__ Very Good__ Good__ Fair__ Poor__

5. On a scale of 1 to 5 where 1 represents "Satisfied" and 5 represents "Dissatisfied", how would you rate your level of overall satisfaction.

1__ 2__ 3__ 4__ 5__

6- Please add any additional comments or suggestions that would be helpful when you use our services:

Name _____ Company _____

Address _____ Telephone/e-mail _____

Can we contact you regarding this survey? YES__ NO__

209-959-7
 209-959-3,4,5,6
 209-959-1,2

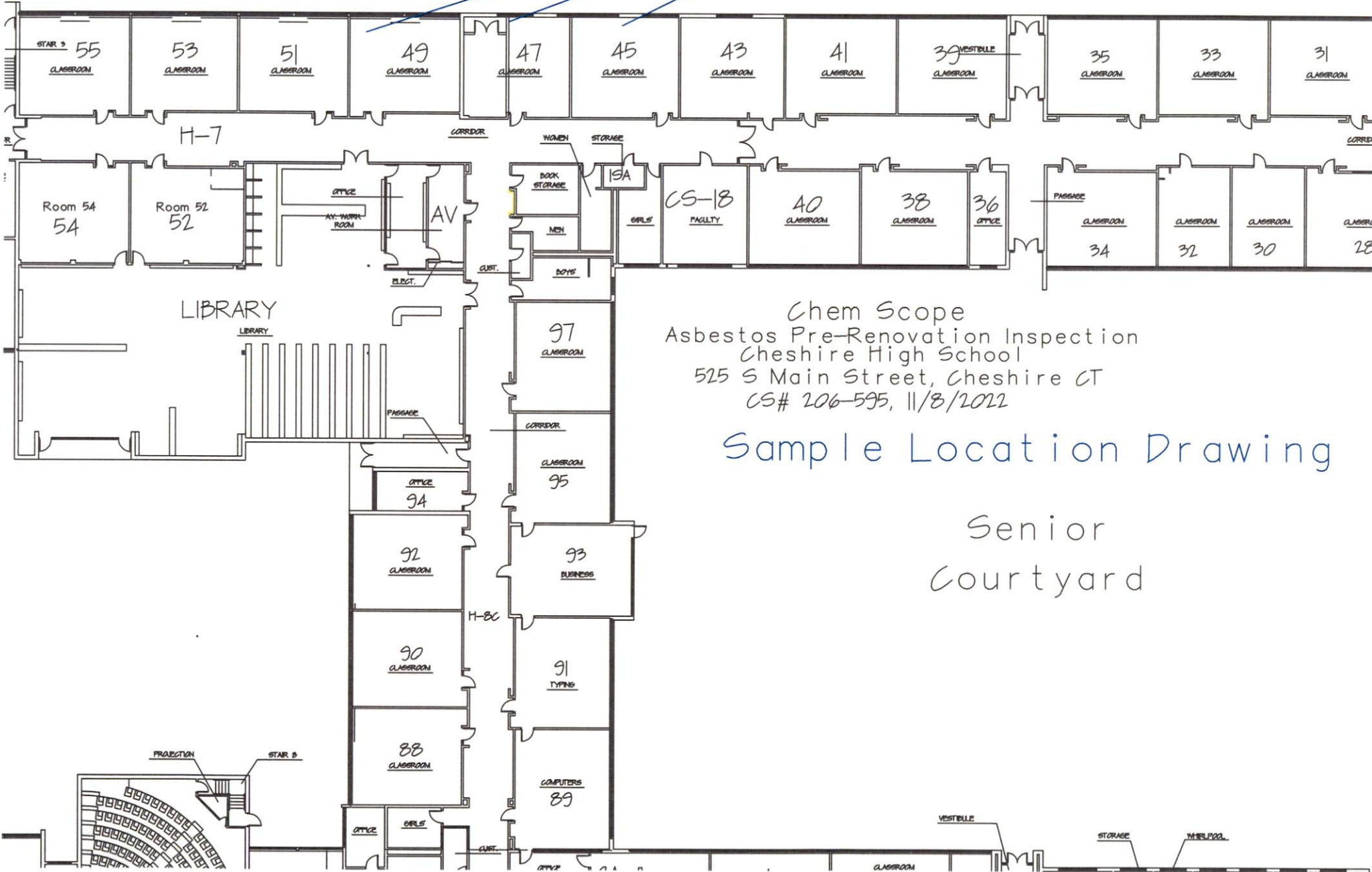

Chem Scope
 Asbestos Pre-Renovation Inspection
 Cheshire High School
 525 S Main Street, Cheshire CT
 CS# 206-595, 11/8/2022

Sample Location Drawing

Senior
 Courtyard

STATE OF CONNECTICUT
DEPARTMENT OF PUBLIC HEALTH

PURSUANT TO THE PROVISIONS OF THE GENERAL STATUTES OF CONNECTICUT

THE INDIVIDUAL NAMED BELOW IS CERTIFIED
BY THIS DEPARTMENT AS A
ASBESTOS CONSULTANT-INSP/MGMT PLANNER

ZIYANG WANG

CERTIFICATE NO
000355

CURRENT THROUGH
07/31/23

VALIDATION NO
03-977225

SIGNATURE

COMMISSIONER

CERT#: A-508-Virtual.634

**CHEMSCOPE TRAINING DIVISION
ASBESTOS INSPECTOR/MANAGEMENT PLANNER REFRESHER
8-HOUR TRAINING CERTIFICATE**

Ziyang Wang

15 Moulthrop Street, North Haven CT

Has attended an 8-hour course on the subject discipline on
09/02/2022 and has passed a written examination.

"The person receiving this certificate has completed the requisite training required for asbestos accreditation as an inspector/management planner under TSCA Title II"

Course topics include a review and update on asbestos health hazards, functions of inspectors and management planners, building systems, planning, inspecting for asbestos, sampling and analysis, respiratory protection, government regulations and preparing the inspection report.

The training course has been accredited by the State of Connecticut.

Examination 1 Score: 98%

Examination 2 Score: 94%

Exam Date: 09/02/2022

Expiration Date: 09/02/2023



Daniel Sullivan
Training Manager

Chem Scope, Inc.
15 Moulthrop Street
North Haven CT 06473
Phone: 203.865.5605
www.chem-scope.com



AIHA Laboratory Accreditation Programs, LLC

acknowledges that

ChemScope, Inc.

15 Moulthrop St North Haven, CT 06473-3633

Laboratory ID: LAP-100134

along with all premises from which key activities are performed, as listed above, has fulfilled the requirements of the AIHA Laboratory Accreditation Programs (AIHA LAP), LLC accreditation to the ISO/IEC 17025:2017 international standard, General Requirements for the Competence of Testing and Calibration Laboratories in the following:

LABORATORY ACCREDITATION PROGRAMS

<input checked="" type="checkbox"/>	INDUSTRIAL HYGIENE	Accreditation Expires: September 01, 2024
<input type="checkbox"/>	ENVIRONMENTAL LEAD	Accreditation Expires:
<input type="checkbox"/>	ENVIRONMENTAL MICROBIOLOGY	Accreditation Expires:
<input type="checkbox"/>	FOOD	Accreditation Expires:
<input type="checkbox"/>	UNIQUE SCOPES	Accreditation Expires:

Specific Field(s) of Testing (FoT)/Method(s) within each Accreditation Program for which the above named laboratory maintains accreditation is outlined on the attached Scope of Accreditation. Continued accreditation is contingent upon successful on-going compliance with ISO/IEC 17025:2017 and AIHA LAP, LLC requirements. This certificate is not valid without the attached Scope of Accreditation. Please review the AIHA LAP, LLC website (www.aihaaccreditedlabs.org) for the most current Scope.

Cheryl O Morton
Managing Director, AIHA Laboratory Accreditation Programs, LLC

United States Department of Commerce
National Institute of Standards and Technology



Certificate of Accreditation to ISO/IEC 17025:2017

NVLAP LAB CODE: 101061-0

ChemScope, Inc.
North Haven, CT

*is accredited by the National Voluntary Laboratory Accreditation Program for specific services,
listed on the Scope of Accreditation, for:*

Asbestos Fiber Analysis

*This laboratory is accredited in accordance with the recognized International Standard ISO/IEC 17025:2017.
This accreditation demonstrates technical competence for a defined scope and the operation of a laboratory quality
management system (refer to joint ISO-ILAC-IAF Communique dated January 2009).*

2022-04-01 through 2023-03-31

Effective Dates



A handwritten signature in black ink, appearing to read "David S. Lerman".

For the National Voluntary Laboratory Accreditation Program

State of Connecticut, Department of Public Health
Approved Environmental Laboratory

THIS IS TO CERTIFY THAT THE LABORATORY DESCRIBED BELOW HAS BEEN APPROVED BY THE STATE DEPARTMENT OF PUBLIC HEALTH PURSUANT TO APPLICABLE PROVISIONS OF THE PUBLIC HEALTH CODE AND GENERAL STATUTES OF CONNECTICUT, FOR MAKING THE EXAMINATIONS, DETERMINATIONS OR TESTS SPECIFIED BELOW WHICH HAVE BEEN AUTHORIZED IN WRITING BY THAT DEPARTMENT.

CHEMSCOPE, INC

LOCATED AT 15 Moulthrop Street IN North Haven, Connecticut 06473

AND REGISTERED IN THE NAME OF DANIEL SULLIVAN

THIS CERTIFICATE IS ISSUED IN THE NAME OF SUZANNE CRISTANTE WHO HAS BEEN DESIGNATED BY THE REGISTERED OWNER \ AUTHORIZED AGENT TO BE IN CHARGE OF THE LABORATORY WORK COVERED BY THIS CERTIFICATE OF APPROVAL AS FOLLOWS:

BUILDING MATERIALS

ASBESTOS FIBERS - PCM
BULK IDENTIFICATION - PLM

SEE COMPUTER PRINT-OUT FOR SPECIFIC TESTS APPROVED

EFFECTIVE RENEWAL DATE April 1, 2021

THIS CERTIFICATE EXPIRES March 31, 2023 AND IS REVOCABLE FOR CAUSE BY THE STATE DEPARTMENT OF PUBLIC HEALTH

DATED AT HARTFORD, CONNECTICUT, THIS 15th DAY OF December, 2021

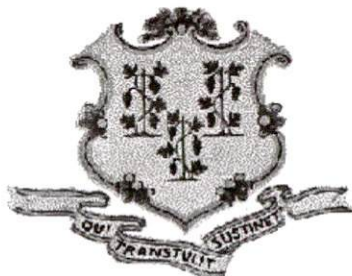

Registration
No.

PH - 0581

Lori J. Mathieu '21

Lori Mathieu
Branch Chief
Environmental Health & Drinking Water Branch